

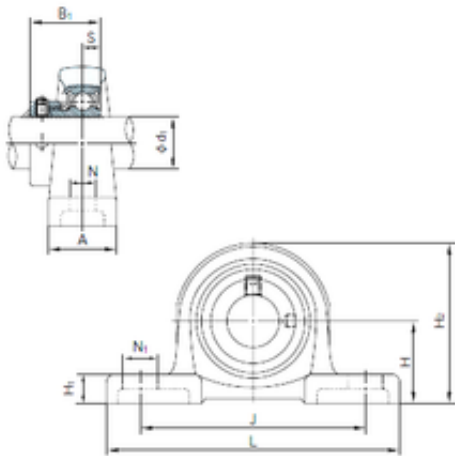

**NACHI KHLLP207AJ Bearing Units**

Bearing No. KHLLP207AJ



KHLLP207AJ Bearing 2D drawings and 3D CAD models

Bore Diameter	35 mm
Width	38.9 mm
d	35 mm
A	35 mm
B	38.9 mm
H	47.6 mm
H1	16 mm
H2	93 mm
J	127 mm
L	165 mm
N	14 mm
N1	21 mm
S	9.5 mm
Bolt (G)	M12